

# TOWMASTER<sup>®</sup>

## Drop-Deck Tilt T-3DT



Positive locking (over-center) latch system keeps deck secured to the frame.



Grommet mounted LED lights are standard.



Sealed battery break-away system charges while plugged into the tow vehicle and can be checked at the press of a button.

### Description:

The T-3DT trailer is a pan type tilt deck and is designed for hauling small equipment and short loads of sand, rock or debris. The deck features a slip-resistant texture and 8-inch high sides. The low deck height is perfect for a low load angle and the slip-resistant deck assists in equipment loading. The T-3DT features a rubber-ride axle for a smooth ride, electric brakes, an adjustable hitch, and a positive locking (over-center) latch system to keep the deck secured to the frame.

### Quick Specs:

- Steel pan deck
- 14" deck height (empty)
- 54" between fenders
- 10' deck
- Electric brakes
- Dexter<sup>®</sup> Torflex<sup>®</sup> axle
- E-Z Lube hubs
- LED Lights and Sealed Wiring

[towmaster.com](http://towmaster.com)

**800-462-4517**

**U.S.A. BUILT  
EMPLOYEE OWNED  
AMERICA'S BEST TRAILER**



**GALVANIZING  
AVAILABLE**



Photos may show optional equipment.

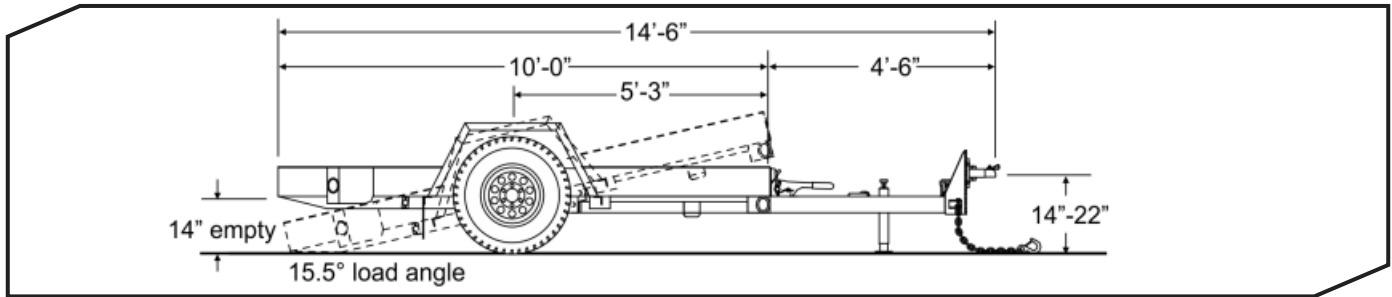

### SPECIFICATIONS

S=Standard O=Optional

T-3DT

#### CAPACITY / DIMENSIONS

Payload Rating (lbs/kg)	3,500 / 1588		
GVWR (lbs/kg)	4,600 / 2086		
GAWR (lbs/kg)	3,500 / 1588		
Approx. Avg. Weight (lbs/kg)	1,100 / 499		
Overall Length (ft-in/mm)	14-6 / 4419		
Deck Height (empty)(in/mm)	14 / 355		
Overall Width (in/mm)	80 / 2032		
Load Width (in/mm)	54 / 1372		

#### TONGUE

Tongue Length 4'-6" (1372mm)	S		
Pintle Ring (in)	2.5		
Safety Chain	3/8" Grade 43		
Bolt-on Drop-Leg Parking Jack	5K		

#### FRAME / RAMPS

Main Beam	4 x 2 Tubing		
Crossmembers	3" Jr I-beam		
Headboard Height (in / mm)	8 / 204		
Deck	Steel Pan		
Deck Lip (in / mm)	8 / 204		
Deck Latch	Single Point		
12 ga. One-piece formed fenders and inner panel	S		
Load Angle (degrees) – depending on deck length	14		
Tie Downs	D-ring		
Number of Tie-Downs (Total / Side)	6 / 3		

#### SUSPENSION / TIRES

Rubber-Ride Axle w/Warranty	S		
Axle Capacity (each) (lbs/kg)	3,500 / 1588		
Axle Spread (in/mm)	N/A		
Hubs	E-Z Lube		
Electric Brakes w/Forward Adjust	S		
Brake Size (in/mm)	10x2.25 / 250x57		
Battery Break-Away Kit with Tow Charger	S		
Wheels (in/mm)	15x6 / 381x152		
Wheel Bolt Pattern	6-bolt		
Tires / Load Range Rating	225/75R15 / D		

#### STANDARD EQUIPMENT

- Adjustable hitch height
- Weather resistant sealed modular wiring
- Grommet mounted LED lights
- Registration holder
- Rust inhibiting primer
- Durable, rust inhibiting top coat
- Die-cut UV resistant vinyl decals
- D.O.T. approved conspicuity tape
- Mud flaps
- RV electrical plug
- Trailer color: Equipment black

#### OPTIONAL EQUIPMENT Other options may be available. Ask your dealer or visit our web site.

- Hydraulic surge brakes
- 6-pole round electrical plug
- Oak wood deck
- Deck cushion cylinder
- Rubber runner pads
- Additional tie-downs
- Spare tire and wheel
- Color options: Construction Yellow, Equipment Red, Blue, Charcoal
- Galvanizing

#### U.S.A. DESIGNED AND BUILT IN LITCHFIELD, MN

\*Payload capacity is calculated by taking the GVWR and subtracting the trailer weight.

Listed GVWR, weights, and dimensions are for reference only. Manufacturer reserves the right to change models and specifications as they see fit. See our web site or your local authorized dealer for more information.