

# TOWMASTER®

Drop-Deck

TC-9D / TC-10D / TC-12D / TC-14D



TC-14D with optional equipment shown



Formed frame and tongue provide a strong and integral structure for the trailer.



Sealed battery break-away system charges while plugged into the tow vehicle and can be checked at the press of a button.



Heavy-duty one-piece formed fender with backing plate keeps tire debris off equipment.

## Description:

The Towmaster® TC provides the perfect value combining the features you need with the quality a Towmaster built trailer offers. This model works well for skid-loaders, mini-excavators and other small equipment and makes a great economical investment. The TC drop-deck is built on a solid cold-formed one-piece I-beam frame with 3-inch I-beam crossmembers and treated pine wood deck. It includes Dexter® Torflex® rubber torsion axles for a smooth ride, bolt-on parking jack, and solid-bar ramp hold-ups.

## Quick Specs:

- 2" nom. treated pine deck (except TC-14D)
- 22.5 deck height (empty)
- 82" between fenders
- 14', 16', 18', or 20' deck (model specific)
- Dexter® Torflex® axles
- Forward adjusting electric brakes
- One-piece formed fender and inner panel
- Solid bar ramp hold-ups
- Grommet mounted LED lights

[towmaster.com](http://towmaster.com)

Photos may show optional equipment.

800-462-4517

U.S.A. BUILT  
EMPLOYEE OWNED



GALVANIZING  
AVAILABLE





# TC-9D / TC-10D / TC-12D / TC-14D

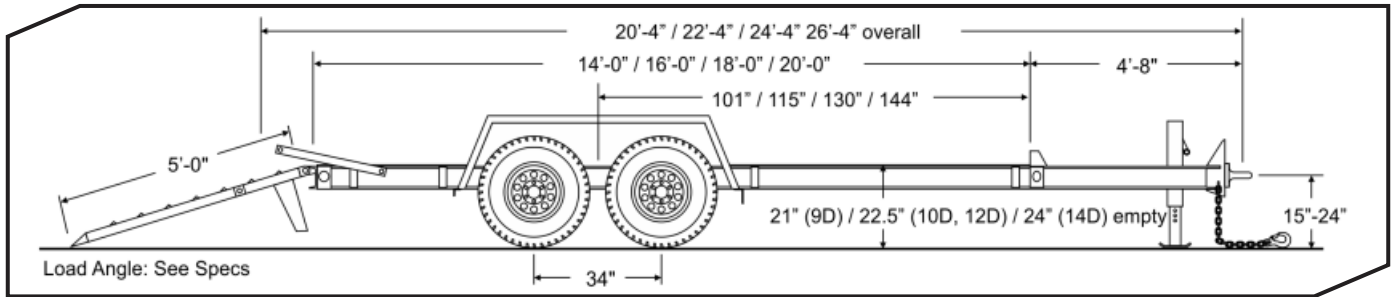

## SPECIFICATIONS

S=Standard O=Optional

CAPACITY / DIMENSIONS	TC-9D	TC-10D	TC-12D	TC-14D
Approx. Payload (lbs/kg)	7,390 / 3352	10,000 / 4536	12,000 / 5443	14,000 / 6350
GVWR (lbs/kg)	9,990 / 4531	12,600 / 5715	14,600 / 6622	16,600 / 7530
GAWR (lbs/kg)	12,000 / 5443	12,000 / 5443	12,000 / 5443	14,000 / 6350
Approx. Avg. Weight (lbs/kg)	2,600 / 1179	2,600 / 1179	2,600 / 1179	2,700 / 1225
Overall Length – 14' (ft-in/mm)	20-4 / 6198	20-4 / 6198	20-4 / 6198	N/A
Overall Length – 16' (ft-in/mm)	22-4 / 6807	22-4 / 6807	22-4 / 6807	22-4 / 6807
Overall Length – 18' (ft-in/mm)	24-4 / 7417	24-4 / 7417	24-4 / 7417	24-4 / 7417
Overall Length – 20' (ft-in/mm)	26-4 / 8027	26-4 / 8027	26-4 / 8027	26-4 / 8027
Deck Height (empty)(in/mm)	21 / 533	22.5 / 572	22.5 / 572	24 / 610
Overall Width (ft-in/mm)	8-6 / 2591	8-6 / 2591	8-6 / 2591	8-6 / 2591
Load Width (in/mm)	82 / 2083	82 / 2083	82 / 2083	82 / 2083
<b>TONGUE</b>				
Tongue Length 5'-0" (1524mm)	S	S	S	S
One-Piece Cold-Formed Tongue / Frame	S	S	S	S
Pintle Ring (in)	2.5	2.5	2.5	3
High-Tensile Safety Chain	3/8" Grade 43	3/8" Grade 43	3/8" Grade 43	3/8" Grade 70
Bolt-on Drop-Leg Parking Jack	7K	7K	7K	12K
<b>FRAME / RAMPS</b>				
Main Beam	6" I-Beam	6" I-Beam	High-Tensile W6 x 12	High Tensile W8 x 10
Crossmembers	3" Jr I-beam	3" Jr I-beam	3" Jr I-beam	3" Jr I-beam
Headboard Height (in / mm)	3 / 76	3 / 76	3 / 76	3 / 76
Deck Lip	N/A	N/A	N/A	N/A
Deck Material	2" nom. Treated Pine	2" nom. Treated Pine	2" nom. Treated Pine	2" nom. White Oak
12 ga. One-piece formed fenders and inner panel	S	S	S	S
Ramps (Ladder Style) Length x Width (ft-in x in/mm)	5-0x18 / 1524x470	5-0x18 / 1524x470	5-0x18 / 1524x470	5-0x18 / 1524x470
Load Angle (degrees)	17	17	17	19
Ramp Spring-Assist	O	O	O	O
Ramp Hold-ups	Solid Bar	Solid Bar	Solid Bar	Solid Bar
Tie Downs	Integrated Formed	Integrated Formed	Integrated Formed	Integrated Formed
Number of Tie-Downs (Total / Side)	8 / 4	8 / 4	8 / 4	8 / 4
<b>SUSPENSION / TIRES</b>				
Rubber-Ride Axles w/Warranty	S	S	S	S
Axle Capacity (each) (lbs/kg)	6,000 / 2721	6,000 / 2721	6,000 / 2721	7,000 / 3175
Axle Spread (in/mm)	34 / 864	34 / 864	34 / 864	34 / 864
Hubs	Standard Lube	Standard Lube	Standard Lube	Standard Lube
Electric Brakes w/Forward Adjust	S	S	S	S
Brake Size (in/mm)	12x2 / 305x51	12x2 / 305x51	12x2 / 305x51	12x2 / 305x51
Battery Break-Away Kit with Tow Charger	S	S	S	S
Wheels (in/mm)	15x6 / 381x152	16x6 / 406x152	16x6 / 406x152	16x6 / 406x152
Wheel Bolt Pattern	6-bolt	6-bolt	6-bolt	8-bolt
Tires / Load Range Rating	ST225/75R15 / D	235/85R16 / E	235/85R16 / E	235/85R16 / E

### STANDARD EQUIPMENT

- Adjustable hitch height
- Weather resistant sealed modular wiring
- Grommet mounted LED lights
- Registration holder
- Rust inhibiting primer
- Durable, rust inhibiting top coat
- Die-cut UV resistant vinyl decals
- DOT conspicuity tape
- Mud flaps
- Adjustable ramp width spacing
- RV electrical plug
- Trailer color: Equipment black
- Ramp color: Equipment red

### OPTIONAL EQUIPMENT

Other options may be available. Ask your dealer or visit our web site.

- Hydraulic surge brakes
- 3" pintle ring or 2-5/16" ball coupler
- Gooseneck hitch
- 6-pole round electrical plug
- 12K parking jack
- Storage tray lid
- Pallet fork holders
- 8K electric winch
- Additional tie-downs
- D-ring tie-downs
- 3 ft. beavertail (comes with 4 ft. ramps)
- E-Z Lube hubs
- Spare tire and wheel mount
- Spare tire and wheel
- Tire upgrades available on select models
- Ramp lift springs
- Auto-Latch ramp hold-ups
- Several ramp options available
- Color options: Construction Yellow, Equipment Red, Blue, Charcoal
- Galvanizing

### U.S.A. DESIGNED AND BUILT IN LITCHFIELD, MN

\*Payload capacity is calculated by taking the GVWR and subtracting the trailer weight.

Listed GVWR, weights, and dimensions are for reference only. Manufacturer reserves the right to change models and specifications as they see fit. See our web site or your local authorized dealer for more information.

www.towmaster.com

800-462-4517

©Towmaster, Inc. 06/2015