

TOWMASTER®

AMERICA'S BEST TRAILER



Description:

This is the original skid-loader trailer from Towmaster®. The Pan trailer features a lower deck height for hauling smaller equipment and skid-loaders. The taller sides also let you haul small loads of dirt, sand, gravel, sod or debris. Dexter® Torflex® rubber torsion axles make this trailer smooth riding. The Pan trailer is built on a special frame with I-beam tongue and 3-inch I-beam cross-members. The deck floor is oak wood with a steel floor available as an option. LED lights and our patented Auto-Latch® ramp hold-ups are standard.



Quick Specs:

- 2" nominal white oak deck, steel optional
- 18" deck height (empty)
- 77" between fenders
- 14', 16', 18' or 20' deck
- Electric brakes with forward adjust
- Dexter® Torflex® axles
- E-Z Lube hubs
- Auto-Latch® Ramps
- LED Lights and Sealed Wiring

Photos may show optional equipment.



Patented Auto-Latch® ramp hold-ups and LED lights are standard.



An optional steel deck with traction aid is available.



"SL" ramp option gives a lower load angle for special equipment like scissor lifts and other small-wheeled vehicles.

towmaster.com

800-462-4517

U.S.A. BUILT EMPLOYEE OWNED



GALVANIZING AVAILABLE



Drop-Deck Pan
T-9P / T-10P / T-12P

T-9P / T-10P / T-12P

AMERICA'S BEST TRAILER

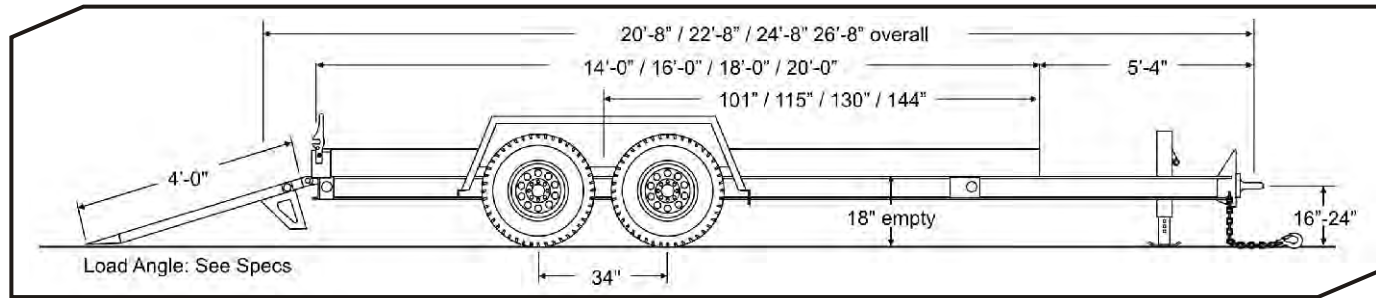

SPECIFICATIONS

S=Standard O=Optional

CAPACITY / DIMENSIONS	T-9P	T-10P	T-12P
Payload Rating (lbs/kg)	6,800 / 3084	10,000 / 4536	12,000 / 5443
GVWR (lbs/kg)	9,990 / 4531	13,200 / 5987	15,200 / 6895
GAWR (lbs/kg)	14,000 / 6350	14,000 / 6350	14,000 / 6350
Approx. Avg. Weight (lbs/kg)	3,200 / 1111	3,200 / 1111	3,200 / 1111
Overall Length – 14' (ft-in/mm)	20-8 / 6299	20-8 / 6299	20-8 / 6299
Overall Length – 16' (ft-in/mm)	22-8 / 6909	22-8 / 6909	22-8 / 6909
Overall Length – 18' (ft-in/mm)	24-8 / 7518	24-8 / 7518	24-8 / 7518
Overall Length – 20' (ft-in/mm)	26-8 / 8128	26-8 / 8128	26-8 / 8128
Deck Height (empty)(in/mm)	18 / 457	18 / 457	18 / 457
Overall Width (ft-in/mm)	8-6 / 2591	8-6 / 2591	8-6 / 2591
Load Width (in/mm)	77 / 1956	77 / 1956	77 / 1956
TONGUE			
Tongue Length 5'-0" (1524mm)	S	S	S
I-beam Tongue	S	S	S
Pintle Ring (in)	2.5	2.5	2.5
3/8" High-Tensile Safety Chain x 40"	Grade 43	Grade 43	Grade 43
Bolt-on Drop-Leg Parking Jack	7K	7K	7K
FRAME / RAMPS			
Main Frame	Fabricated	Fabricated	Fabricated
Crossmembers	3" Jr I-beam	3" Jr I-beam	3" Jr I-beam
Headboard Height (in / mm)	7 / 178	7 / 178	7 / 178
Deck	2" nom. White Oak	2" nom. White Oak	2" nom. White Oak
Deck Lip (in / mm)	7 / 178	7 / 178	7 / 178
Ramps Length x Width (ft-in x in/mm)	4-0x16 / 1219x406	4-0x16 / 1219x406	4-0x16 / 1219x406
Load Angle (degrees)	15	15	15
Ramp Spring-Assist	S	S	S
Ramp Hold-ups	Auto-Latch	Auto-Latch	Auto-Latch
Tie Downs	D-ring	D-ring	D-ring
Number of Tie-Downs (Total / Side)	8 / 4	8 / 4	8 / 4
SUSPENSION / TIRES			
Rubber-Ride Axles w/Warranty	S	S	S
Axle Capacity (each) (lbs/kg)	7,000 / 3175	7,000 / 3175	7,000 / 3175
Axle Spread (in/mm)	34 / 864	34 / 864	34 / 864
Hubs	E-Z Lube	E-Z Lube	E-Z Lube
Electric Brakes w/Forward Adjust	S	S	S
Brake Size (in/mm)	12x2 / 305x51	12x2 / 305x51	12x2 / 305x51
Battery Break-Away Kit with Tow Charger	S	S	S
Wheels (in/mm)	16x6 / 406x152	16x6 / 406x152	16x6 / 406x152
Wheel Bolt Pattern	8-bolt	8-bolt	8-bolt
Tires / Load Range Rating	235/85R x 16 / E	235/85R x 16 / E	235/85R x 16 / E

STANDARD EQUIPMENT

- Adjustable hitch height
- Weather resistant sealed modular wiring
- Grommet mounted LED lights
- Registration holder
- Rust inhibiting primer
- Durable, rust inhibiting top coat
- Die-cut UV resistant vinyl decals
- D.O.T. approved conspicuity tape
- Mud flaps
- Adjustable ramp width spacing
- RV electrical plug
- Trailer color: Equipment black
- Ramp color: Equipment red

OPTIONAL EQUIPMENT

Other options may be available
See your dealer or visit our web site for details

- Hydraulic surge brakes
- 3" pintle ring or 2-5/16" ball coupler
- Gooseneck hitch
- 6-pole round electrical plug
- Storage tray lid
- 12K parking jack
- Steel deck
- Pallet fork holders
- 8K electric winch
- Additional tie-downs
- Spare tire and wheel mount
- Spare tire and wheel
- Several ramp options available
- "SL" ramp option for hauling scissor lifts
- Color options: Construction Yellow, Equipment Red, Equipment Blue, Equipment Charcoal
- Galvanizing

U.S.A. DESIGNED AND BUILT IN LITCHFIELD, MN

*Listed GVWR and weights are for reference only. Weights can vary due to options installed.

All dimensions are approximate. Check our website or see your authorized dealer for more information.

Manufacturer reserves the right to modify, change or discontinue models or options as seen fit without obligation to previously sold units. Written warranty covers each trailer. Photos may not show most recent changes to models.